

Maximum 507 kW (680 hp) @1800 RPM (CONTINUOUS DUTY)

STANDARD EQUIPMENT

MGX-5170DC

- Vertical offset, cast iron housing
- Electric GP-valve with manual override
- EC050 Profile module
 - interface for engagement signals
- Oil strainer and oil filter

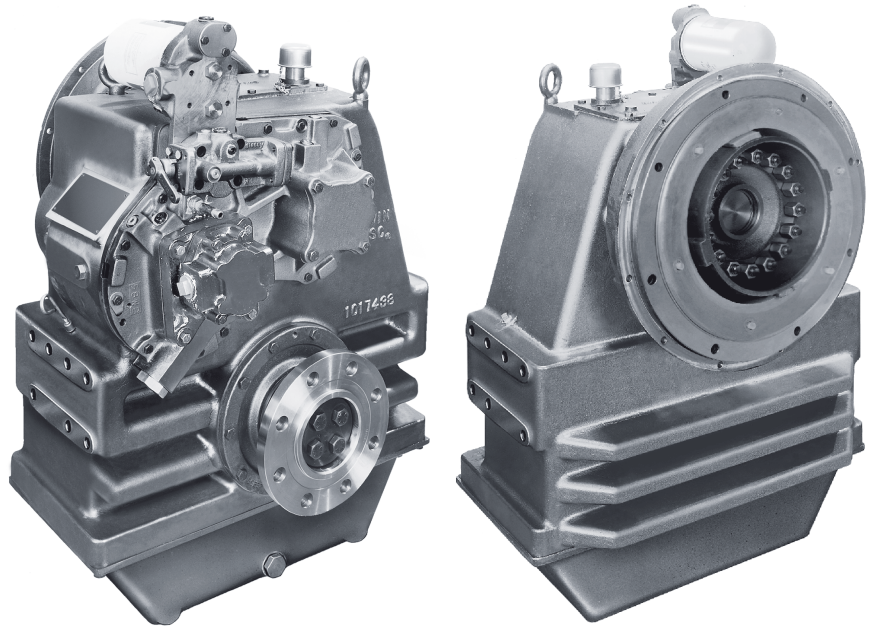

INPUT RATINGS - KILOWATTS (KW) (HORSEPOWER (HP))*

For service classification definitions and important notes refer to www.twindisc.com, the Twin Disc Marine Product Guide or contact Twin Disc directly.

Reduction Ratios :1	Intermediate Duty		Medium Duty		Continuous Duty	
	@ 1800 RPM	@ 2100 RPM	@ 1600 RPM	@ 1800 RPM	@ 1600 RPM	@ 1800 RPM
3.12, 3.54, 4.06 4.50, 5.03, 5.95	537 kW (720 hp)	578 kW (775 hp)	475 kW (637 hp)	537 kW (720 hp)	448 kW (601 hp)	507 kW (680 hp)
6.53, 6.95	467 kW (626 hp)	545 kW (731 hp)	415 kW (557 hp)	459 kW (615 hp)	408 kW (547 hp)	459 kW (615 hp)

* Ratings shown for use with standard right-hand rotation engines.
The maximum allowable rated engine speed is 2500 rpm.



Specifications subject to change without prior notice in the interest of continual product improvement.
Contact your local Twin Disc representative for engineering specifications, Survey Society Approvals and Classifications.

Scan QR code to see Twin Disc's entire Marine product line.



OPTIONS

SAE J617 housing no. 1

SAE J617 housing no. 0

Flexible coupling for 14" flywheel (SAE J620 size 355)

Flexible coupling for 18" flywheel (SAE J620 size 460)

Input hub for freestanding installation

Mechanical control valve

EC050 E-Troll module – interface for engagement & trolling signals

Harness with single point interface to Twin Disc EC300 control system

Oil cooler with thermostatic bypass valve

Companion flange/ bolts set

Monitoring devices to customer's specification

Mounting brackets

Live PTO

SAE J744 size 127-2/4, 32-4 (SAE "C", 2/4-bolt) – max. 592 Nm

SAE J744 size 127-2/4, 38-4 (SAE "C-C", 2/4-bolt) – max. 1187 Nm

Hydraulic Clutchable pump mount PTO

SAE J744 size 127-2/4, 32-4 (SAE "C", 2/4-bolt) – max. 592 Nm

SAE J744 size 127-2/4, 38-4 (SAE "C-C", 2/4-bolt) – max. 1186 Nm

Dry weight incl. SAE #1 housing and SAE 355 flexible coupling: **850 kg**

MGX-5170DC

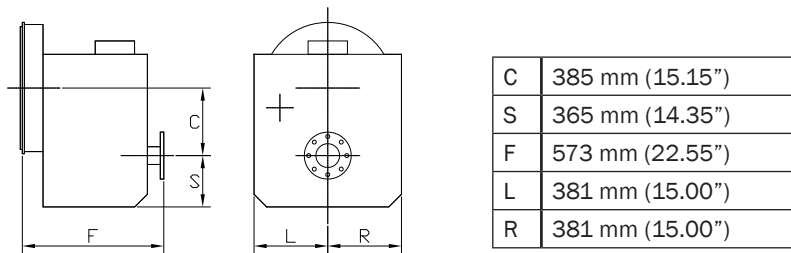

Twin Disc, Incorporated reminds users of these products that their safe operation depends on use in compliance with engineering information provided in our catalog. Users are also reminded that safe operation depends on proper installation, operation and routine maintenance and inspection under prevailing conditions. It is the responsibility of users (and not Twin Disc, Incorporated) to provide and install guards or safety devices which may be required by recognized safety standards or by the Occupational Safety and Health Act of 1970 and its subsequent provisions.

United States of America • Australia • Belgium • Canada • China • India • Italy • Singapore • Switzerland

For nearly a century, we've been making boats perform better and more reliably. From system-design consultation to application development to in-service support, Twin Disc provides fully integrated propulsion solutions that will optimize your craft's performance, reliability and safety over the years. Bring Twin Disc aboard early in the development process, and you'll enjoy a lifetime of enhanced operating value.

TRANSMISSIONS • ELECTRONIC CONTROLS • EXPRESS JOYSTICK SYSTEM® • SAILDRIVES • EXPRESS POSITIONING® • ARNESON SURFACE DRIVES • MARINE CONTROL DRIVES • ROLLA PROPELLERS • BOW & STERN THRUSTERS • STEERING SYSTEMS • RUDDERS • TRIM TABS



Twin Disc, Incorporated
Racine, Wisconsin 53403 USA
Phone +1-262-638-4000
Fax +1-262-638-4482
www.twindisc.com

TD-Bulletin-MGX-5170DC
© 2016, Twin Disc, Incorporated
Printed in the USA - 1/2016